

| NPS | L | D | D1 | D2 | b | f | n-Ød |
|-------|-----|-----|-------|-------|------|---|-------|
| 2 | 178 | 150 | 120.7 | 92.1 | 14.3 | 2 | 4-Ø19 |
| 2-1/2 | 190 | 180 | 139.7 | 104.8 | 15.9 | 2 | 4-Ø19 |
| 3 | 203 | 190 | 152.4 | 127.0 | 17.5 | 2 | 4-Ø19 |
| 4 | 229 | 230 | 190.5 | 157.2 | 22.3 | 2 | 4-Ø19 |
| 5 | 254 | 255 | 215.9 | 185.7 | 22.3 | 2 | 8-Ø22 |
| 6 | 267 | 280 | 241.3 | 215.9 | 22.9 | 2 | 8-Ø22 |
| 8 | 292 | 345 | 298.5 | 269.9 | 27.0 | 2 | 8-Ø22 |

Technical Specifaion

1. Design & manufacture according to API 600;
2. Flange size dimension according to ASME B16.5;
3. Structure length size dimension according to ASME B16.10;
4. Inspection & test according to API 598;

Performance

| | | |
|------------------------|---------------------|-----|
| Nominal Pressure | 150LB | MPa |
| Strength test pressure | 3.0 | |
| Seal test pressure | 2.0 | |
| Air seal pressure | 0.6 | |
| Temperature | -29~425°C | |
| Medium | Water.air.steam.gas | |

GATE VALVE

J-VALVES

Construction

150LB RF

Page

1

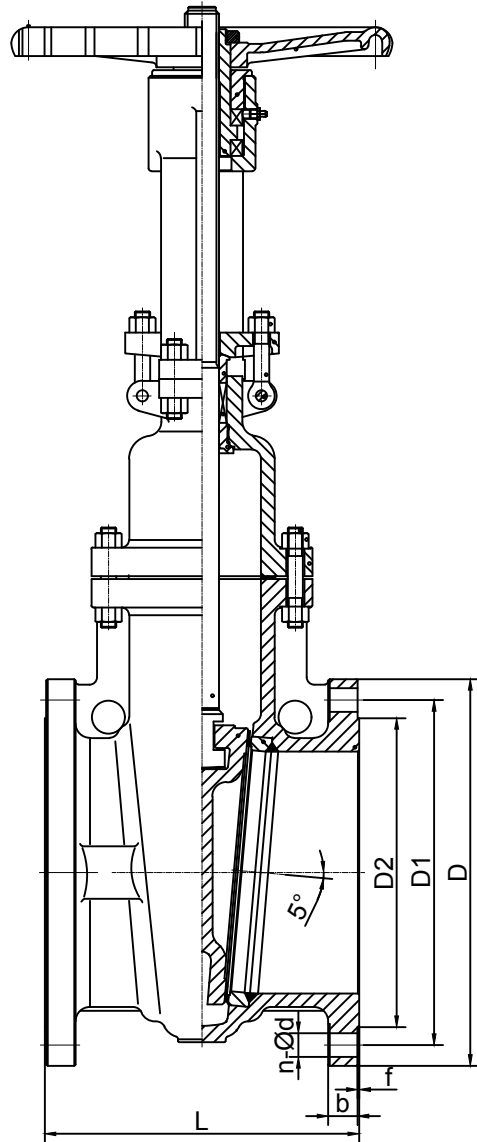

| NPS | L | D | D1 | D2 | b | f | n-Ød |
|-----|-----|------|--------|--------|------|---|--------|
| 10 | 330 | 405 | 362.0 | 323.8 | 28.6 | 2 | 12-Ø25 |
| 12 | 356 | 485 | 431.8 | 381.0 | 30.2 | 2 | 12-Ø25 |
| 14 | 381 | 535 | 476.3 | 412.8 | 33.4 | 2 | 12-Ø29 |
| 16 | 406 | 595 | 539.8 | 469.9 | 35.0 | 2 | 16-Ø29 |
| 18 | 432 | 635 | 577.9 | 533.4 | 38.1 | 2 | 16-Ø32 |
| 20 | 457 | 700 | 635.0 | 584.2 | 41.3 | 2 | 20-Ø32 |
| 24 | 508 | 815 | 749.3 | 692.2 | 46.1 | 2 | 20-Ø35 |
| 26 | 559 | 870 | 606.4 | 749.0 | 66.7 | 2 | 24-Ø35 |
| 28 | 610 | 925 | 863.6 | 800.0 | 69.9 | 2 | 28-Ø35 |
| 30 | 610 | 985 | 914.4 | 857.0 | 73.1 | 2 | 28-Ø35 |
| 32 | 711 | 1060 | 977.9 | 914.0 | 79.4 | 2 | 28-Ø41 |
| 36 | 711 | 1170 | 1085.5 | 1022.0 | 88.9 | 2 | 32-Ø41 |

| Technical Specificaion | |
|------------------------|---|
| 1. | Design & manufacture according to API 600; |
| 2. | Flange size dimension according to ASME B16.5/ASME B16.47B; |
| 3. | Structure length size dimension according to ASME B16.10; |
| 4. | Inspection & test according to API 598; |

| Performance | |
|------------------------|---------------------|
| Nominal Pressure | 150LB |
| Strength test pressure | 3.0 |
| Seal test pressure | 2.0 |
| Air seal pressure | 0.6 |
| Temperature | -29~425°C |
| Medium | Water.air.steam.gas |

| | | | | | |
|--|--|------------|--|----------|--|
| | | GATE VALVE | | J-VALVES | |
| | | | | | |
| | | Page 1 | | 150LB RF | |
| | | | | | |

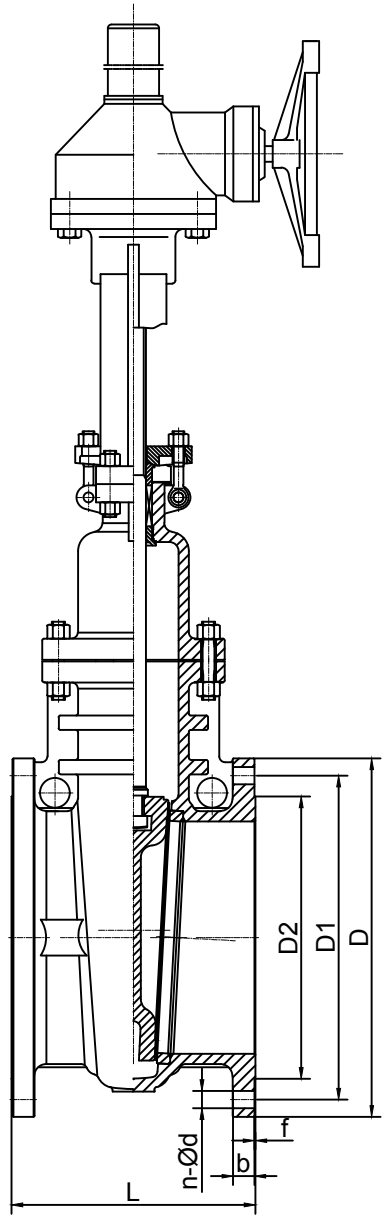

| NPS | L | D | D1 | D2 | b | f | n-Ød |
|-----|-----|------|--------|--------|------|---|--------|
| 10 | 330 | 405 | 362.0 | 323.8 | 28.6 | 2 | 12-Ø25 |
| 12 | 356 | 485 | 431.8 | 381.0 | 30.2 | 2 | 12-Ø25 |
| 14 | 381 | 535 | 476.3 | 412.8 | 33.4 | 2 | 12-Ø29 |
| 16 | 406 | 595 | 539.8 | 469.9 | 35.0 | 2 | 16-Ø29 |
| 18 | 432 | 635 | 577.9 | 533.4 | 38.1 | 2 | 16-Ø32 |
| 20 | 457 | 700 | 635.0 | 584.2 | 41.3 | 2 | 20-Ø32 |
| 24 | 508 | 815 | 749.3 | 692.2 | 46.1 | 2 | 20-Ø35 |
| 26 | 559 | 870 | 806.4 | 749.0 | 66.7 | 2 | 24-Ø35 |
| 28 | 610 | 925 | 863.6 | 800.0 | 69.9 | 2 | 28-Ø35 |
| 30 | 610 | 985 | 914.4 | 857.0 | 73.1 | 2 | 28-Ø35 |
| 32 | 711 | 1060 | 977.9 | 914.0 | 79.4 | 2 | 28-Ø41 |
| 36 | 711 | 1170 | 1085.5 | 1022.0 | 88.9 | 2 | 32-Ø41 |

| Technical Specifaion | |
|----------------------|---|
| 1、 | Design & manufacture according to API 600; |
| 2、 | Flange size dimension according to ASME B16.5/ASME B16.47B; |
| 3、 | Structure length size dimension according to ASME B16.10; |
| 4、 | Inspection & test according to API 598; |

| Performance | |
|------------------------|---------------------|
| Nominal Pressure | 150LB |
| Strength test pressure | 3.0 |
| Seal test pressure | 2.0 |
| Air seal pressure | 0.6 |
| Temperature | -29~425°C |
| Medium | Water.air.steam.gas |

| | | | | | | | |
|--|--|--|--|------------|--|--------------|--|
| | | | | GATE VALVE | | J-VALVES | |
| | | | | | | Construction | |
| | | | | Page 1 | | 150LB RF | |

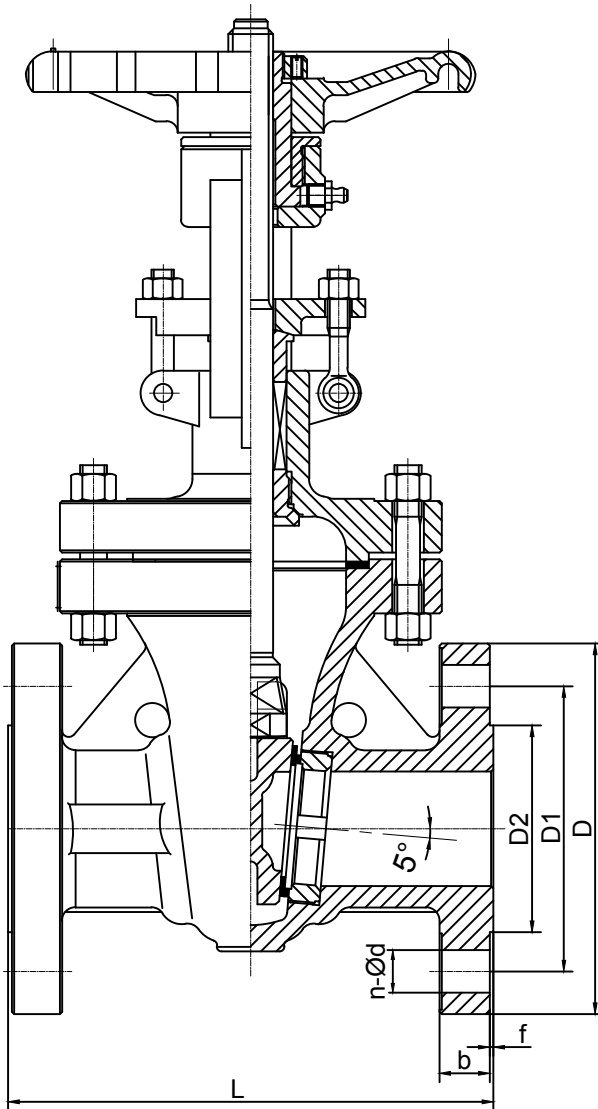

| NPS | L | D | D1 | D2 | b | f | n-Ød |
|-------|-----|-----|-------|-------|------|---|--------|
| 2 | 216 | 165 | 127.0 | 92.1 | 20.7 | 2 | 8-Ø19 |
| 3 | 282 | 210 | 168.3 | 127.0 | 27.0 | 2 | 8-Ø22 |
| 4 | 305 | 255 | 200.0 | 157.2 | 30.2 | 2 | 8-Ø22 |
| 5 | 381 | 280 | 235.0 | 185.7 | 33.4 | 2 | 8-Ø22 |
| 2-1/2 | 241 | 190 | 149.2 | 104.8 | 23.9 | 2 | 8-Ø22 |
| 6 | 403 | 320 | 269.9 | 215.9 | 35.0 | 2 | 12-Ø22 |
| 8 | 419 | 380 | 330.2 | 269.9 | 39.7 | 2 | 12-Ø25 |

Technical Specificaion

1. Design & manufacture according to API 600;
2. Flange size dimension according to ASME B16.5;
3. Structure length size dimension according to ASME B16.10;
4. Inspection & test according to API 598;

Performance

| | | |
|------------------------|---------------------|-----|
| Nominal Pressure | 300LB | |
| Strength test pressure | 7.7 | MPa |
| Seal test pressure | 5.6 | |
| Air seal pressure | 0.6 | |
| Temperature | -29~425°C | |
| Medium | Water,air,steam,gas | |

| | | | | |
|--|--|------------|--------------|----------|
| | | GATE VALVE | J-VALVES | |
| | | | Construction | |
| | | | | 300LB RF |

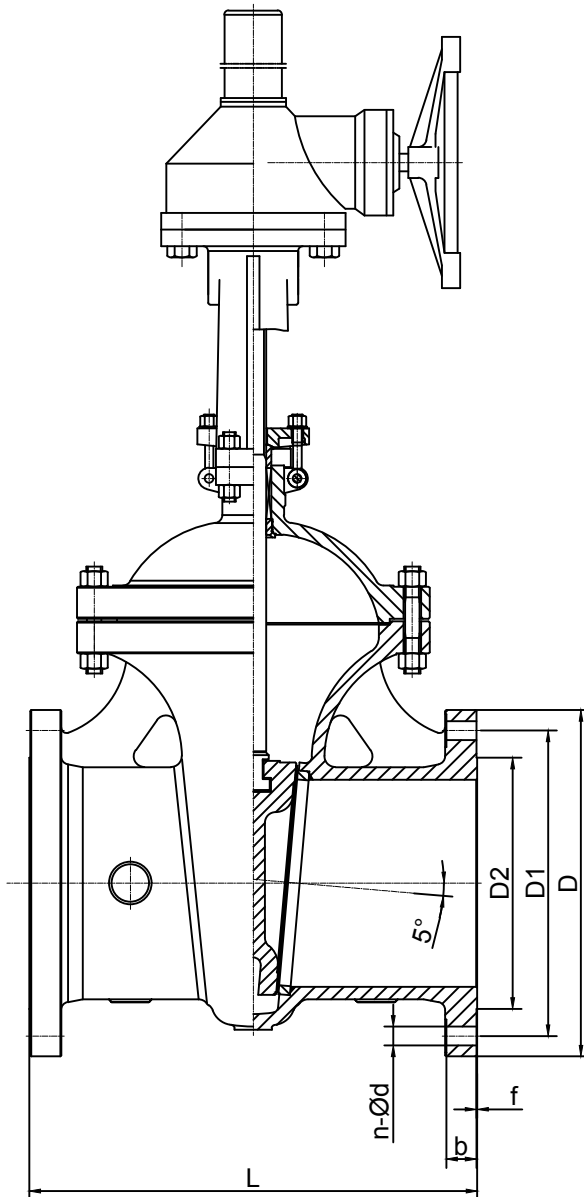

| NPS | L | D | D1 | D2 | b | f | n-Ød |
|-----|------|------|--------|--------|-------|---|--------|
| 10 | 457 | 445 | 387.4 | 323.8 | 46.1 | 2 | 16-Ø29 |
| 12 | 502 | 520 | 450.8 | 381.0 | 49.3 | 2 | 16-Ø32 |
| 14 | 762 | 585 | 514.4 | 412.8 | 52.4 | 2 | 20-Ø32 |
| 16 | 838 | 650 | 571.5 | 469.9 | 55.6 | 2 | 20-Ø35 |
| 18 | 914 | 710 | 628.6 | 533.4 | 58.8 | 2 | 24-Ø35 |
| 20 | 991 | 775 | 685.8 | 584.2 | 62.0 | 2 | 24-Ø35 |
| 24 | 1143 | 915 | 812.8 | 692.2 | 68.3 | 2 | 24-Ø41 |
| 26 | 1245 | 970 | 876.3 | 749.0 | 77.8 | 2 | 28-Ø44 |
| 28 | 1346 | 1035 | 939.8 | 800.0 | 84.2 | 2 | 28-Ø44 |
| 30 | 1397 | 1090 | 997.0 | 857.0 | 90.5 | 2 | 28-Ø47 |
| 32 | 1524 | 1150 | 1054.1 | 914.0 | 96.9 | 2 | 28-Ø50 |
| 36 | 1727 | 1270 | 1168.4 | 1022.0 | 103.2 | 2 | 32-Ø54 |

| Technical Specification |
|--|
| 1、 Design & manufacture according to API 600; |
| 2、 Flange size dimension according to ASME B16.5/ASME B16.47B; |
| 3、 Structure length size dimension according to ASME B16.10; |
| 4、 Inspection & test according to API 598; |

| Performance | |
|------------------------|---------------------|
| Nominal Pressure | 300LB |
| Strength test pressure | 7.7 |
| Seal test pressure | 5.6 |
| Air seal pressure | 0.6 |
| Temperature | -29~425°C |
| Medium | Water.air.steam.gas |

| | | | | | | | | | |
|--|--|--|--|------------|--|--|--|--------------|--|
| | | | | GATE VALVE | | | | J-VALVES | |
| | | | | | | | | Construction | |
| | | | | Page 1 | | | | 300LB RF | |

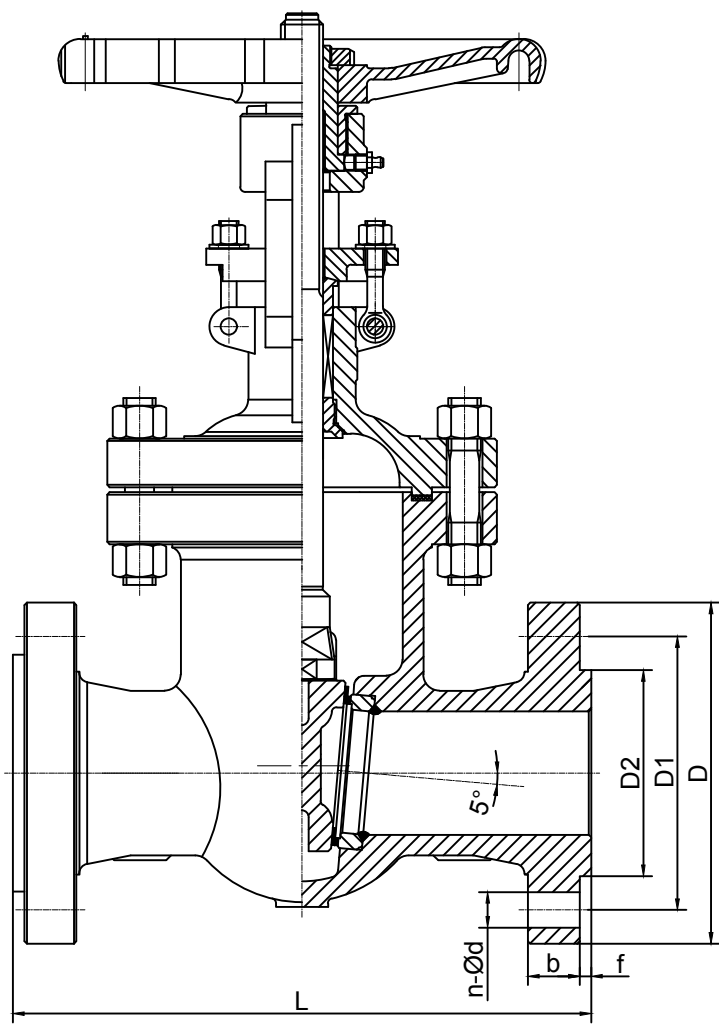

| NPS | L | D | D1 | D2 | b | f | n-Ød |
|-------|-----|-----|-------|-------|------|---|--------|
| 2 | 216 | 165 | 127.0 | 92.1 | 20.7 | 2 | 8-Ø19 |
| 2-1/2 | 241 | 190 | 149.2 | 104.8 | 23.9 | 2 | 8-Ø22 |
| 3 | 282 | 210 | 168.3 | 127.0 | 27.0 | 2 | 8-Ø22 |
| 4 | 305 | 255 | 200.0 | 157.2 | 30.2 | 2 | 8-Ø22 |
| 5 | 381 | 280 | 235.0 | 185.7 | 33.4 | 2 | 8-Ø22 |
| 6 | 403 | 320 | 269.9 | 215.9 | 35.0 | 2 | 12-Ø22 |
| 8 | 419 | 380 | 330.2 | 269.9 | 39.7 | 2 | 12-Ø25 |

| Technical Specifaicon | |
|-----------------------|---|
| 1、 | Design & manufacture according to API 600; |
| 2、 | Flange size dimension according to ASME B16.5; |
| 3、 | Structure length size dimension according to ASME B16.10; |
| 4、 | Inspection & test according to API 598; |

| Performance | |
|------------------------|---------------------|
| Nominal Pressure | 600LB |
| Strength test pressure | 15.4 |
| Seal test pressure | 11.2 |
| Air seal pressure | 0.6 |
| Temperature | -29~425°C |
| Medium | Water.air.steam.gas |

| | | | | | | | |
|--|--|--|--|------------|--|--------------|--|
| | | | | GATE VALVE | | J-VALVES | |
| | | | | | | Construction | |
| | | | | Page 1 | | 600LB RF | |

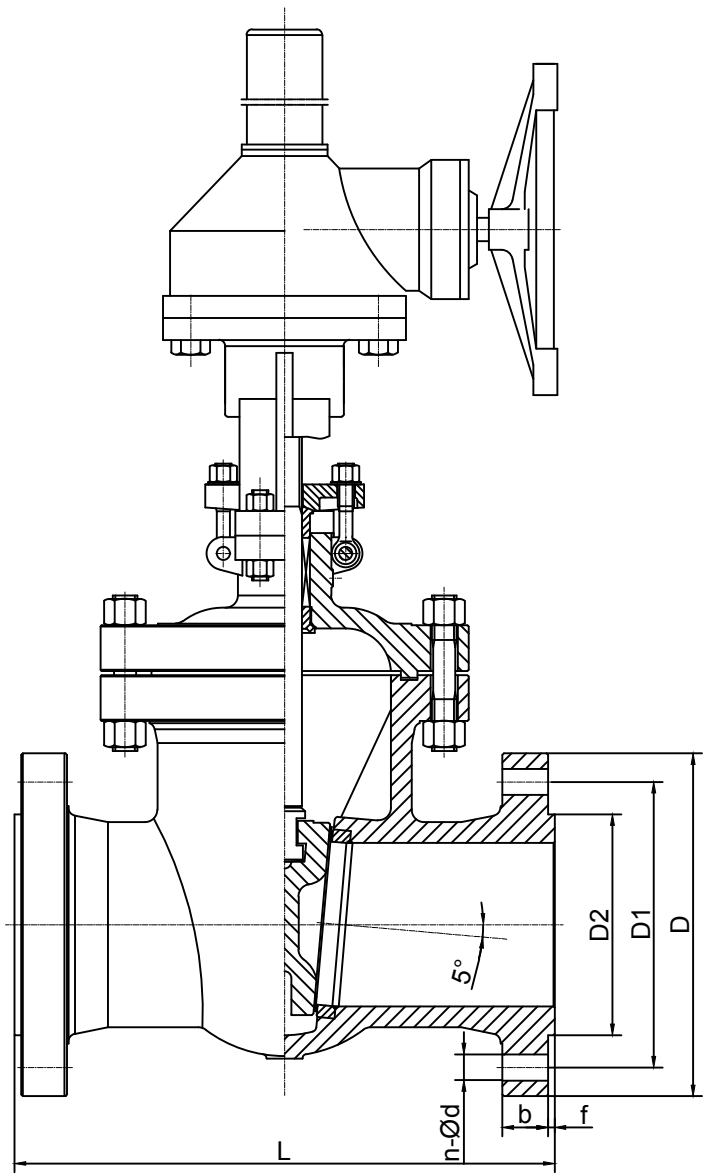

| NPS | L | D | D1 | D2 | b | f | n-Ød |
|-----|------|-----|-------|-------|-------|---|--------|
| 10 | 787 | 510 | 431.8 | 323.8 | 63.5 | 7 | 16-Ø35 |
| 12 | 838 | 560 | 489 | 381 | 66.7 | 7 | 20-Ø35 |
| 14 | 914 | 605 | 527 | 412.8 | 69.9 | 7 | 20-Ø38 |
| 16 | 991 | 685 | 603.2 | 469.9 | 76.2 | 7 | 20-Ø41 |
| 18 | 1092 | 745 | 654 | 533.4 | 82.6 | 7 | 20-Ø45 |
| 20 | 1194 | 815 | 723.9 | 584.2 | 88.9 | 7 | 24-Ø45 |
| 24 | 1295 | 940 | 838.2 | 692.2 | 101.6 | 7 | 24-Ø51 |

| Technical Specifaicon | |
|-----------------------|---|
| 1、 | Design & manufacture according to API 600; |
| 2、 | Flange size dimension according to ASME B16.5; |
| 3、 | Structure length size dimension according to ASME B16.10; |
| 4、 | Inspection & test according to API 598; |

| Performance | |
|------------------------|---------------------|
| Nominal Pressure | 600LB |
| Strength test pressure | 15.4 |
| Seal test pressure | 11.2 |
| Air seal pressure | 0.6 |
| Temperature | -29~425°C |
| Medium | Water.air.steam.gas |

| | | | | | | | | | |
|--|--|--|--|------------|--|--|--|--------------|--|
| | | | | GATE VALVE | | | | J-VALVES | |
| | | | | | | | | Construction | |
| | | | | Page | | | | 600LB RF | |
| | | | | 1 | | | | | |

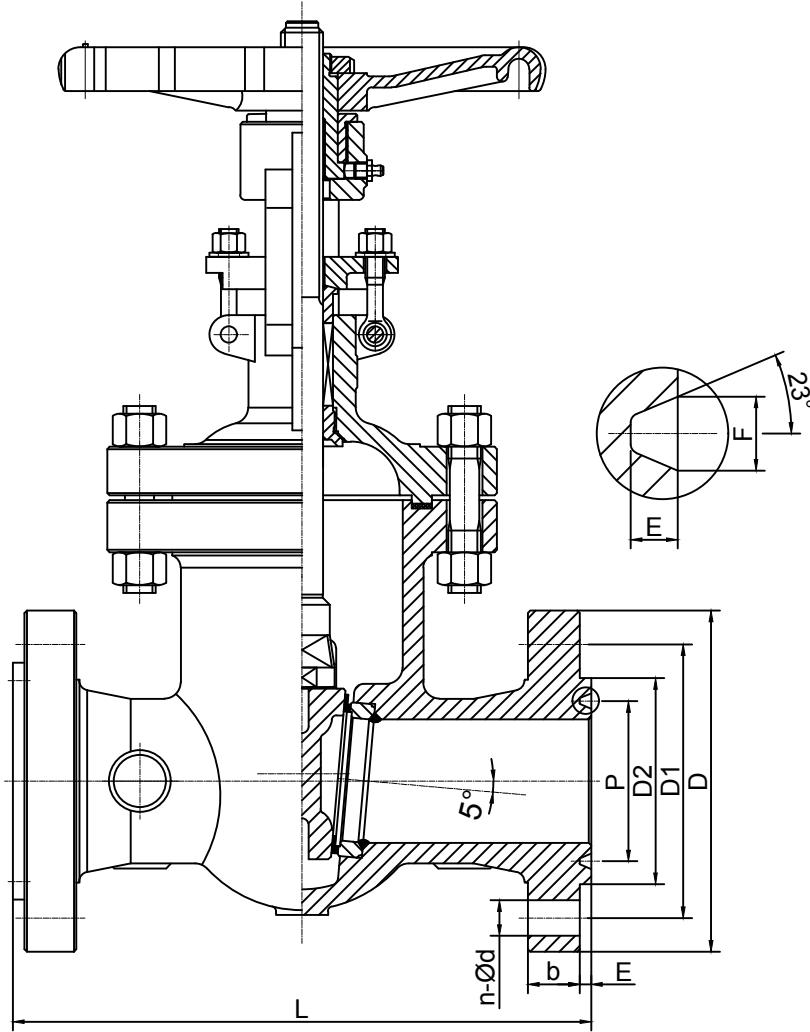

| NPS | L | D | D1 | D2 | P | E | F | b | n-Ød |
|--------|-----|-----|-------|-----|--------|------|-------|------|--------|
| 2" | 371 | 215 | 165.1 | 124 | 95.25 | 7.92 | 11.91 | 38.1 | 8-Ø26 |
| 2-1/2" | 422 | 245 | 190.5 | 127 | 101.6 | 7.92 | 11.91 | 41.3 | 8-Ø29 |
| 3" | 384 | 240 | 190.5 | 156 | 123.83 | 7.92 | 11.91 | 38.1 | 8-Ø26 |
| 4" | 460 | 290 | 235 | 181 | 149.23 | 7.92 | 11.91 | 44.5 | 8-Ø32 |
| 5" | 562 | 350 | 279.4 | 216 | 180.98 | 7.92 | 11.91 | 50.8 | 8-Ø35 |
| 6" | 613 | 380 | 317.5 | 241 | 211.12 | 7.92 | 11.91 | 55.6 | 12-Ø32 |
| 8" | 740 | 470 | 393.7 | 308 | 269.88 | 7.92 | 11.91 | 63.5 | 12-Ø38 |

| Performance | |
|------------------------|----------|
| Nominal pressure | 900LB |
| Strength test pressure | 22.5 MPa |
| Seal test pressure | 16.5 MPa |
| Air seal pressure | 0.6 MPa |
| Max.temperature | ≤ 425° C |
| Water.oil.gas etc. | Medium |

| | | | | | |
|------------|--|--|--|--------------|--|
| GATE VALVE | | | | J-VALVES | |
| | | | | Construction | |
| Page 1 | | | | 900LB RTJ | |
| | | | | | |

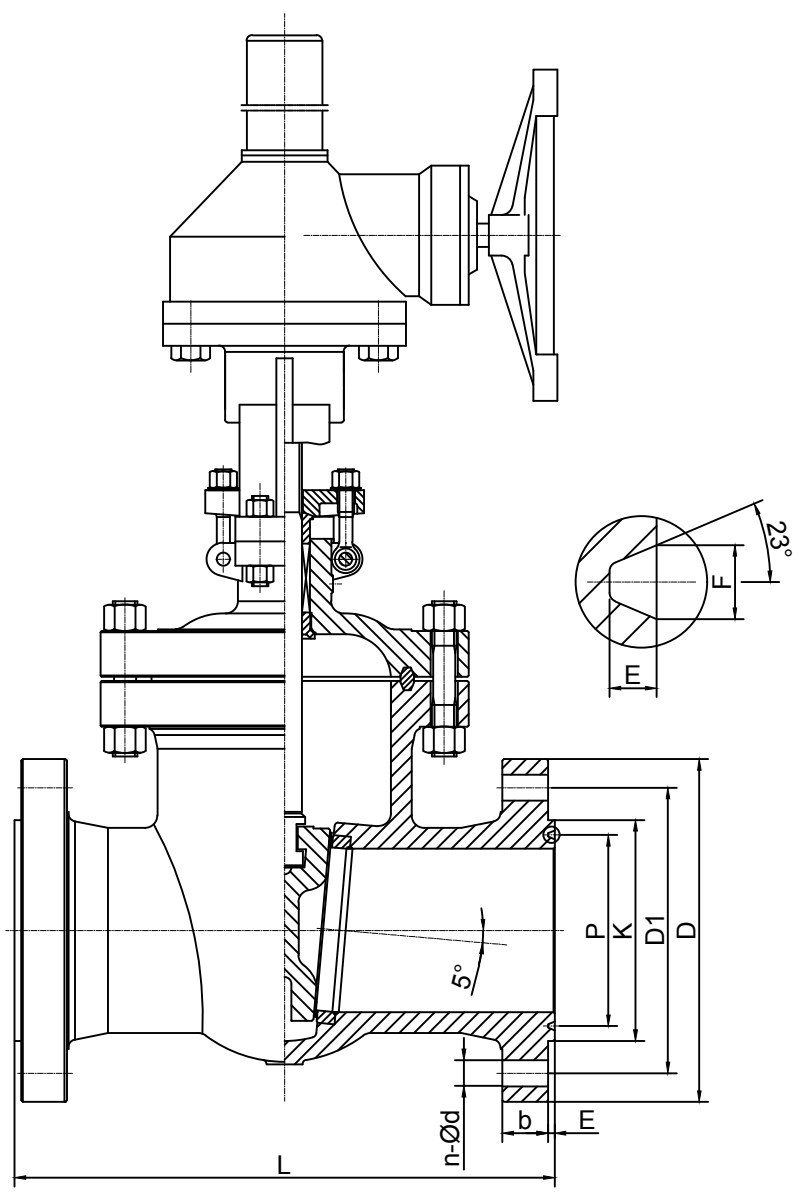

| NPS | L | D | D1 | K | P | E | F | b | n-Ød |
|-----|------|------|-------|-----|--------|-------|-------|-------|--------|
| 10" | 841 | 545 | 469.9 | 362 | 323.85 | 7.92 | 11.91 | 69.9 | 12-Ø38 |
| 12" | 968 | 610 | 533.4 | 419 | 381 | 7.92 | 11.91 | 79.4 | 20-Ø38 |
| 14" | 1039 | 640 | 558.8 | 467 | 419.1 | 11.13 | 16.66 | 85.8 | 20-Ø41 |
| 16" | 1140 | 705 | 616 | 524 | 469.9 | 11.13 | 16.66 | 88.9 | 20-Ø45 |
| 18" | 1232 | 785 | 685.8 | 594 | 533.4 | 12.7 | 19.84 | 101.6 | 20-Ø51 |
| 20" | 1334 | 855 | 749.3 | 648 | 584.2 | 12.7 | 19.84 | 108 | 20-Ø54 |
| 24" | 1568 | 1040 | 901.7 | 772 | 692.15 | 15.88 | 26.97 | 139.7 | 20-Ø67 |

| | | | | | | | |
|--|--|--|--|------------|--|--------------|--|
| | | | | GATE VALVE | | J-VALVES | |
| | | | | | | Construction | |
| | | | | Page 1 | | 900LB RTJ | |